

BT ADSL Microfilter

ADSL enables fast Internet to be delivered to you on your standard telephone line. It allows you to surf the Internet, use e-mail or many other internet applications whilst still carrying on using your telephone, answer machine, fax or any of other piece of telephony equipment that you have attached to your line.

To ensure the quality of both the telephony and the ADSL every piece of telephony equipment must be filtered including telephones, fax machines and even simple tone callers. This does not mean that every piece of equipment must have a filter, only that every telephone socket that has telephony equipment attached to it must have a Microfilter fitted first. The diagrams below show you how to connect your telephony equipment and the ADSL modem you have installed. A standard telephone doubler can be used in the Microfilter "Phone" socket to enable you to plug in another telephony device or extension cable (an ADSL modem cannot be used at the end of this extension cable).

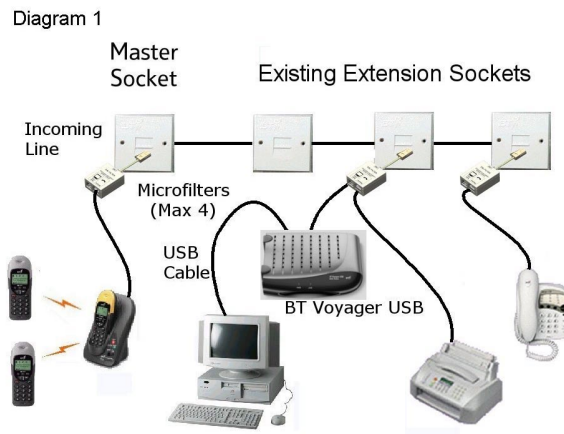

The Microfilter sockets are clearly labelled.

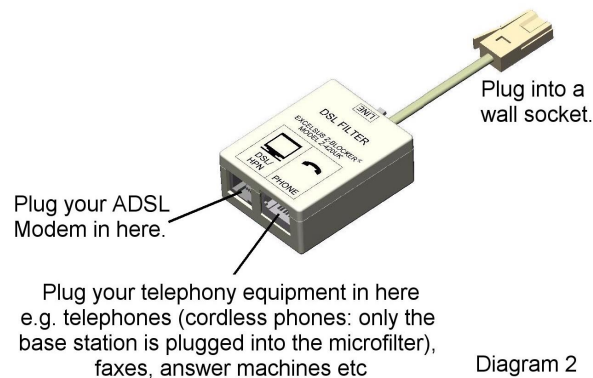

BT ADSL Microfilters are designed to operate in the configuration, as in Diagram 1. Incorrect filters may cause problems with either your telephony products or impede the ADSL speeds.

If you would like additional network-compliant microfilters from BT, please call on 0800 800 060 and ask for a BT ADSL Microfilter.